

I usually determine the hardscape materials first, because that is the largest surface in relationship to the house. I select bluestone paving for all horizontal surfaces, except for gravel as a material for the greenhouse area, the north and south paths, and the meditation area in the front. Having gravel as a different material provides a subtle way-finding cue to keep visitors on the path to the front door. Vertical hardscape surfaces will be a multicolored stone that blends the bluestone paving with warmer tones on the house. Edging, where it is required to keep grass or gravel where it belongs, will be powder-coated steel.

I decide to construct the greenhouse of recycled materials. The construction and materials will depend on what I find at a salvage center. The

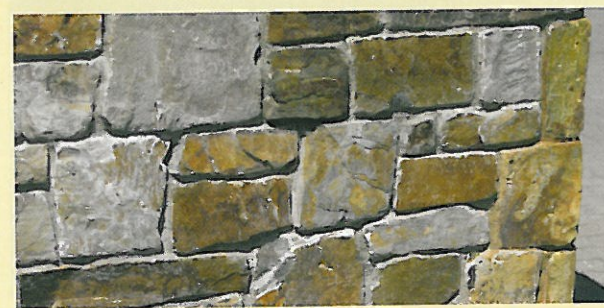

The horizontal hardscape material will be bluestone, except where I have noted quarter-minus gravel.



The vertical hardscape material will be a variably colored stone, except where I have noted the material to be wood; there are many varieties available from an assortment of areas. This stone coordinates well with the bluestone and the existing stone on the house.

surround of the HVAC unit and the bonsai table will be an ornamental box of perforated, powder-coated steel. The perforation is necessary to allow for air-flow to the HVAC unit. This box may relate to the art proposed for the fence on the opposite side of the dining area. All of the fencing, the gates, and the garbage shelter will be varied-width cedar in a simple, regular horizontal pattern. The rhythm created by both the wood fencing and the bluestone pavers, in combination with the repetition of the vertical stone, will tie the entire garden together. I am relating the language of the landscape to the language of the house.

The hardscape finishes plan locates the finishes I have selected for the hypothetical garden.

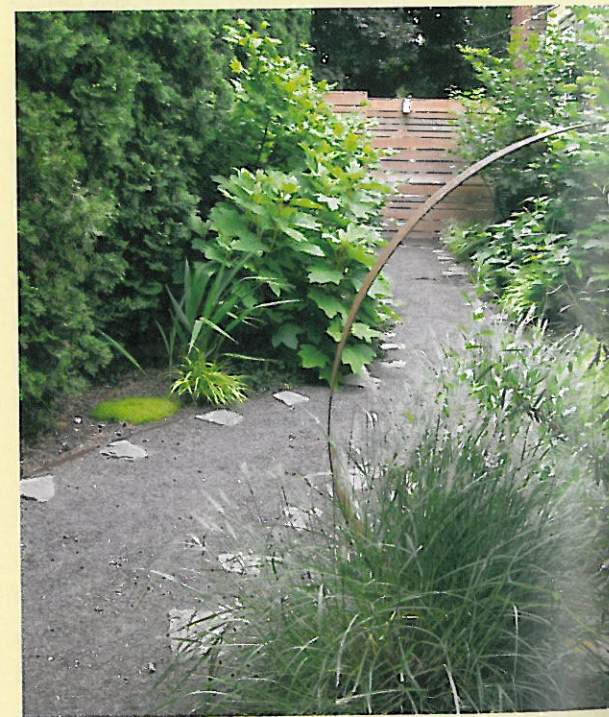

The wood fencing, gate, garbage shelter, and overhead structures in the hypothetical garden will be cedar and similar in material and design to the fencing at the end of the path in this lovely side garden. Garden of Kristien Forness, owner of Fusion Landscape Design, LLC.

